

DO NOT SCALE

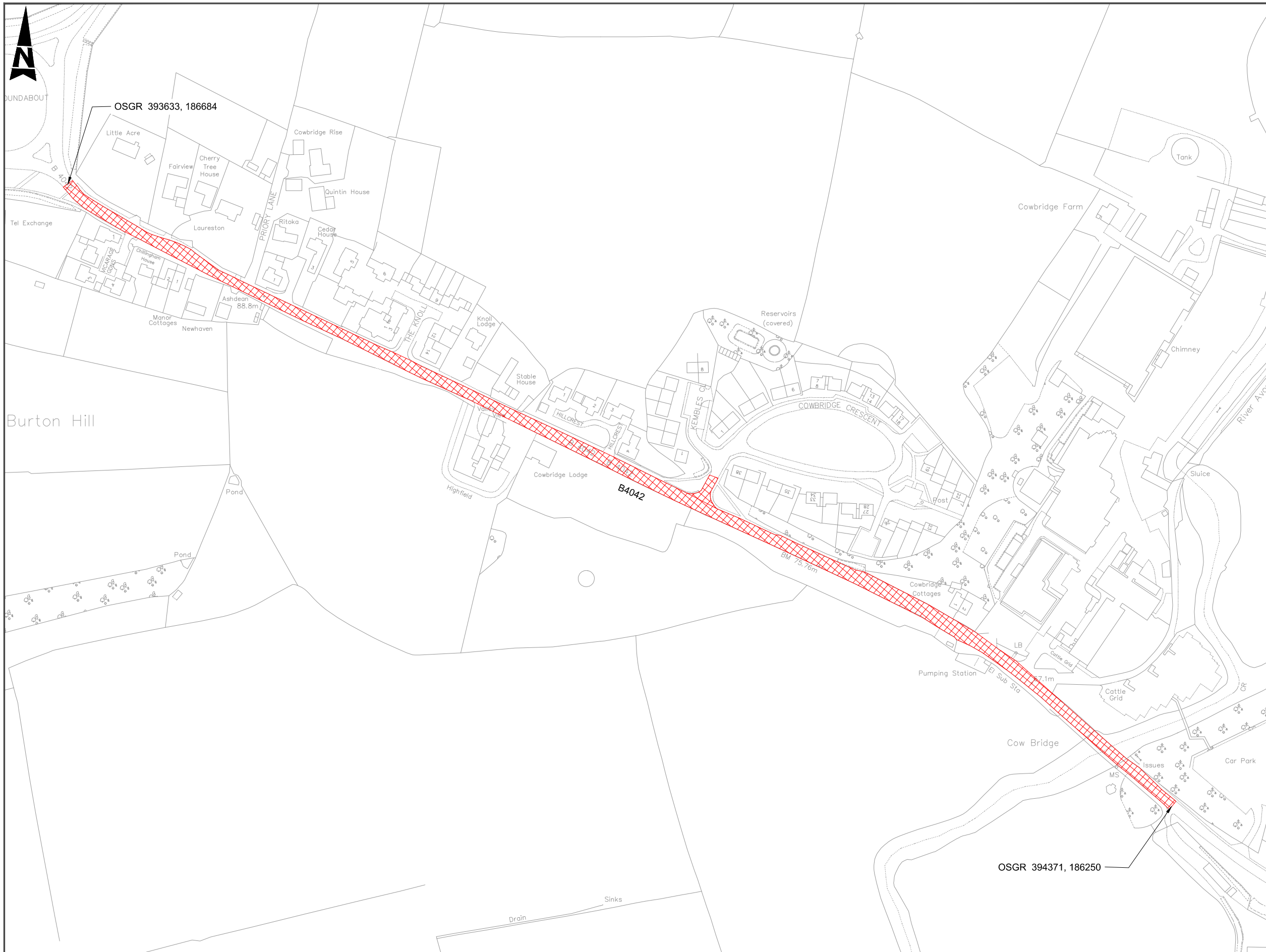

- Notes**
- Limits of work are approximate and are to be agreed on site with the Engineer.
  - Chainage 0m is located at Centre of entrance to Willis Bros fencing access chaining West.

**Key**

Site Extent

WC Brief No: 02 16 02  
 Client Finance Code: 63 23 28  
 Works Order No: TBC  
 Postal Area: SN16

USRN: 28600709  
 Grid Ref: 393633, 186684 to 394371, 186250  
 Philips Street Atlas: Page 28 B2 to C1  
 Road Speed Limit: 40mph

SAFETY, HEALTH AND ENVIRONMENTAL INFORMATION	
IN ADDITION TO THE HAZARDS/RISKS NORMALLY ASSOCIATED WITH THE TYPES OF WORK DETAILED ON THIS DRAWING, NOTE THE FOLLOWING SIGNIFICANT RESIDUAL RISKS	
CONSTRUCTION	NONE
MAINTENANCE/CLEANING	NONE
USE	NONE
DECOMMISSIONING/DEMOLITION	NONE

THIS MAP IS REPRODUCED FROM ORDNANCE SURVEY MATERIAL WITH THE PERMISSION OF ORDNANCE SURVEY ON BEHALF OF THE CONTROLLER OF HER MAJESTY'S STATIONERY OFFICE. © CROWN COPYRIGHT. UNAUTHORISED REPRODUCTION INFRINGES CROWN COPYRIGHT AND MAY LEAD TO PROSECUTION OR CIVIL PROCEEDINGS. 100049050, 2014

Stat	Purpose of Issue	Date	Auth	Rev	Description
S2	Fit for Information	30/04/18	WJ	C1	First Issue

**ATKINS**  
 Atkins Limited  
 Consulting Engineers,  
 County Gate, County Way  
 Trowbridge, Wiltshire  
 BA14 7FJ  
 Tel: 01225 730360  
 www.atkinsglobal.com

**Wiltshire Council**  
 Where everybody matters

Client  
 Project  
 Major Maintenance 2018/2019  
 Surface Only Schemes 2018/2019

Title B4042 Swindon Road, Malmesbury Site Extents	
Sheet Size <b>A3</b>	Original Scale NTS
Designed/Drawn SR	Checked DR
Date 19/12/17	Date 22/12/17
Authorised WJ	Date 30/04/18
Status S2	Drawing Number WHCC_HM-ATK-HGN-1819-S00602-DR-D-0003
Rev C1	